

Instructions for use

Please read this manual completely and follow the directions carefully before using this product, even if you have used a similar injection pen device before.

This product is a disposable pen for the injection of insulin lispro. Each pen contains in total of 300 units of insulin lispro. This pen can deliver doses between 1 unit and 60 units in 1 unit increments.

The pen plunger moves with each dose. The plunger will only move to the end of the cartridge when 300 units of insulin have been given.

The primary container closure system is a 3 mL cartridge with plunger and cartridge cap with rubber liner. The cartridge is sealed in a pre-filled injection pen. There is no needle in the package.

If your pen is in the refrigerator, take it out 1 to 2 hours before you inject it to allow it to reach room temperature. The pain of cold insulin injection is stronger.

Check the insulin cartridge carefully before use and the cartridge should be filled with a colorless and clear solution. The solution should be used only if it is as clear, colorless, and has no visible particles as water. This product is a ready-to-use injector and there is no need to mix it before use.

Empty injection devices cannot be reused and should be disposed of in accordance with local waste regulations.

Each injection device should only be used by one person to prevent the spread of diseases.

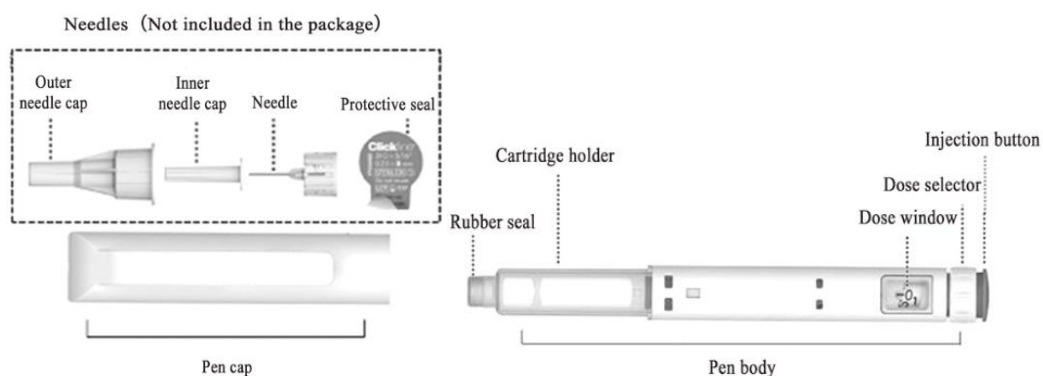

Important items for using this pre-filled insulin glargine pen

- Install a new needle and conduct safety tests before each use. Use only a needle suitable for this pre-filled injection device.
- Take care to avoid needle pricks and spreading diseases.
- Don't use it when the pre-filled injection pen is broken or we cannot ensure whether it can work properly.

- Keep one on hand in case it gets lost and damaged and you can't get it on time
- Needles applicable to this product include:

BD Microfine Ultra®	32G X 4 mm
BD Microfine Ultra®	31G X 5 mm
BD Microfine Ultra®	31G X 8 mm
BD Microfine Ultra®	29G X 12.7mm
GanleeFine™	0.30x6mm/30G
GanleeFine™	0.30x8mm/30G
GanleeFine™	0.25x6mm/31G
GanleeFine™	0.25x8mm/31G
GanleeFine™	0.23x4mm/32G

Preservation guide

Refer to storage information.

If this product is stored under low-temperature conditions, take it out 1-2 hours before injection to bring it to room temperature. The pain of cold insulin injection is stronger.

The used product should be discarded as required.

This product should be properly kept and kept out of the reach and sight of children.

Maintenance of pre-filled pens

Prevent dust from entering the product.

Wipe the surface with a damp cloth to keep it clean.

Do not soak, wash this product, or use additives, which may damage this product. Please operate carefully to avoid easy damage to the product.

If you think this product may be damaged, please replace it with a new one before using it.

Do not attempt to repair damaged pre-filled injection pens on your own. If you have any questions, please contact the company.

Operation Steps

Step 1 Check the product

- The label on the product should be checked to confirm that it is the correct insulin and that the product is within its validity period-this is especially important if you have other similar

products. The pre-filled injection pen of insulin glargine is white with a blue injection button.

- Pull off the cap, check the appearance of insulin. This product is a clear, colorless solution with no visible particles.

Step 2 Attach a new needle

Use only a needle suitable for this pre-filled injection pen. Use a new sterile needle for each injection. **Do not** re-use needles.

- Take off the pen cap of your pen. Wipe the rubber seal with an alcohol swab.

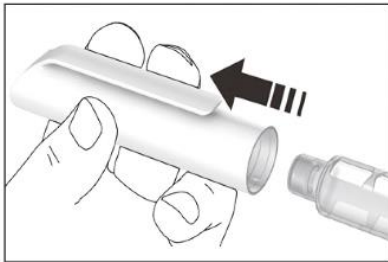

- Remove the protective seal from a new needle.

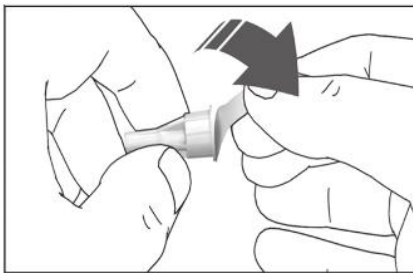

- Line up the needle with the pen, and keep it straight as you attach it, screw the needle tight onto the product making sure it is properly installed.

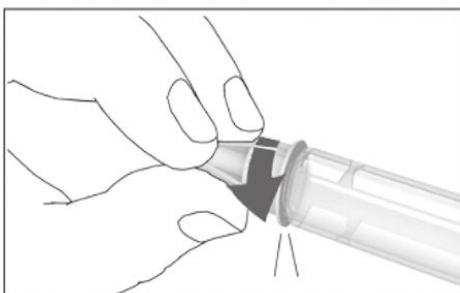

- Note: Make sure the needle position is firm after tightening. If the needle is not kept straight, it can damage the rubber seal and cause leakage, or break the needle.

Step 3 Priming / functional test

Prior to each injection, the system must be primed in order to remove air bubbles from the cartridge for accurate dosing and /or to ensure that the needle is not blocked.

- Select a dose of 2 units by turning the dose selector clockwise (2 clicks).

If necessary, the selected dose can be corrected by turning the dose selector back down.

- Pull off the outer pen needle cap and keep it for use after the injection.
- Pull off the inner pen needle cap and discard it.

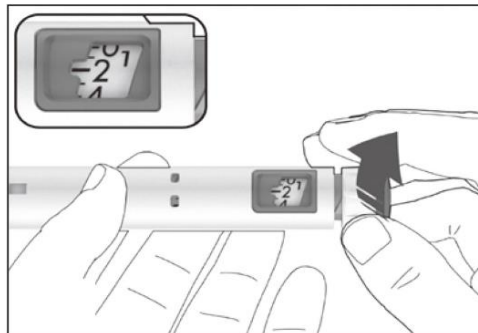

- Hold the pen in an upright position (pen needle pointing up). Tap slightly with your finger on the cartridge holder to allow potential air bubbles within the cartridge to rise up. Press the injection -button all the way until a hard stop is felt to discharge the dose. Number '0' is visible in the display window and aligns with the dose indicator.

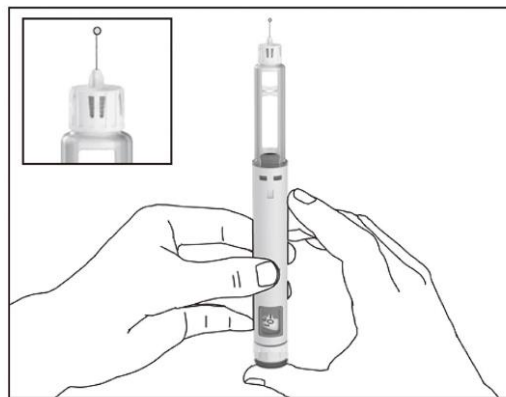

Check whether a droplet of liquid shows at the tip of the needle. Your pen is working correctly if a drop shows at the needle.

If no drops appear:

- Check for air bubbles and repeat the safety test two more times to remove them.
- If still no insulin comes out, the needle may be blocked. Change the needle

and repeat the safety test.

- If no insulin comes out after changing the needle, this product may be damaged - **do not** use this product.

Check that the dose window shows “0” following the safety test.

Step 4. Setting the dose

- Turn the dose selector clockwise until the prescribed dose aligns with the dose indicator in the dose window. Turn 1 click of dose selector is 1 unit. The minimum dose is 1 unit and the maximum dose is 60 units. If your dose is larger than 60 units, two or more times injection should be performed.

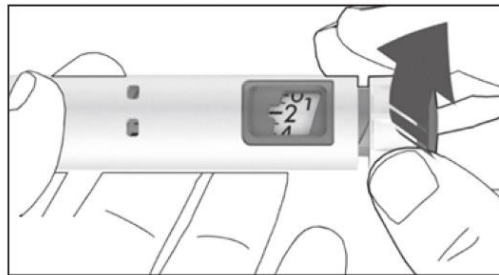

Important Notes:

- If you turn past your dose, you can turn back down.
- To avoid insulin leakage, **Do not** press the injection button while turning the dose selector.
- You cannot turn the dose selector past the number of units left in the pen.
- If your dose is larger than the remaining drug volume in the cartridge, a new pen should be used for the remaining dose.

Step 5. Inject the dose

Before proceeding with the injection, read step 5 carefully, or use the injection technique recommended by your doctor or healthcare professional.

- Hold the pen so that the dose window is visible during the injection.
- Insert the needle into the skin and press the injection-button in all the way until a hard stop is felt and the number ‘0’ is visible in the dose window and aligns with the dose indicator.
- When the complete dose has been delivered, keep the injection-button pressed for another 10 seconds. This ensures that the full dose is delivered.

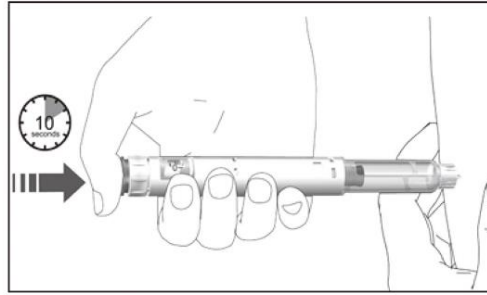

Step 6. Disposal of needle

After each injection, always remove the needle to prevent contamination and/or infection, air bubbles entering into the cartridge, and insulin leakage. Do not reuse the needle.

Special care should be taken when removing and disposing of the used needles. Pull out and discard needles according to the recommended safety methods to reduce the risk of needle pricking and disease transmission.

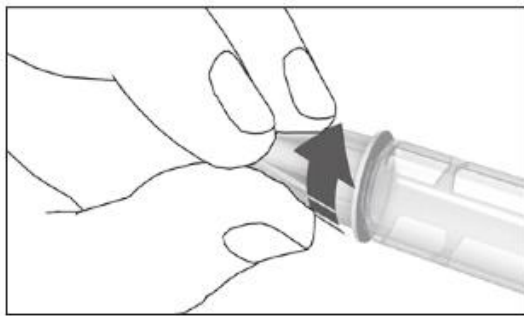

Firmly attach the pen cap to the pen for protection between injections

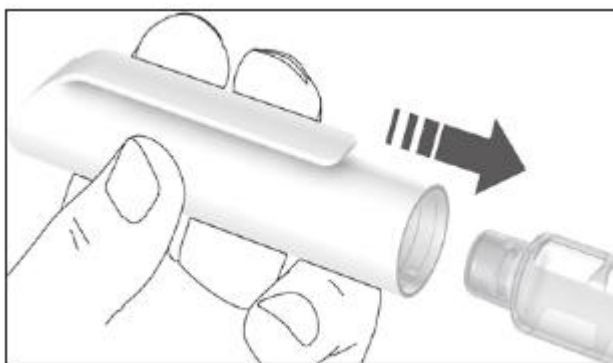

Step 7 Dispose of the empty pen

When the pen is empty, throw it away without a needle on, as instructed by your health care professional or local authorities.

storage

Before first use

- Keep your pen in the refrigerator between 2°C–8°C until first use.
- **Do not** freeze. Throw away your pen if it has been frozen.

After first use

- Store the pen you are currently using at room temperature below 25°C, and away from light, dust and dirt.
- Pen in use must not be stored in a refrigerator.
- Once you take your pen out of the refrigerator, you can use it for up to 28 days. **Do not** use it after this time.
- **Do not** store your pen with the needle attached.